

NORTHWOOD COMMERCE CENTRE

4590 QANTAS LANE

WAREHOUSE/MANUFACTURING FACILITY • STOCKTON, CA

FOR LEASE

±26,880 SF

\$.34 NNN

For more information, contact:

RYAN MCSHANE

T 209.476.2910

Ryan.mcshane@cbre.com

www.cbre.com/ryan.mcshane

ANDREW MUSTIN

T 209.476.2930

Andrew.mustin@cbre.com

www.cbre.com/andrew.mustin

CB Richard Ellis

1776 W. March Lane, Ste. 170

Stockton, CA 95207

T 209.476.7800

F 209.476.2960

www.cbre.com/stockton



For additional information log on to www.cbre.com/stockton. Click on "Team Listings"

PROPERTY FEATURES:

- ± 26,880 SF Available
- ± 22' Clear height
- (2) Grade level doors and (3) dock high loading doors
- Located in State Enterprise Zone
- Zoned Heavy Industrial, City of Stockton
- Close proximity to State Hwy 99 & I-5
- 200 Amps, 277/480 V, 3 Phase
- ± 3,000 SF Office; 4 private offices
- Alarmed
- Concrete tilt-up construction
- Outside security lighting
- Fully Sprinklered
- Attractive showroom
- Ample parking

COMMENTS:

Located in the Stockton Airport Business Center; This ±26,880 SF unit has approximately 3,000 SF of office, skylights, dock high Loading doors, showroom and is in close proximity to Hwy 99.

©2007, CB Richard Ellis, Inc. We obtained the information above from sources we believe to be reliable. However, we have not verified its accuracy and make no guarantee, warranty or representation about it. It is submitted subject to the possibility of errors, omissions, change of price, rental or other conditions, prior sale, lease or financing, or withdrawal without notice. We include projections, opinions, assumptions or estimates for example only, and they may not represent current or future performance of the property. You and your tax and legal advisors should conduct your own investigation of the property and transaction.

CBRE
CB RICHARD ELLIS

NORTHWOOD COMMERCE CENTRE

4590 QANTAS LANE

WAREHOUSE/MANUFACTURING FACILITY • STOCKTON, CA

FOR LEASE

±26,880 SF

\$.34 NNN

For more information, contact:

RYAN MCSHANE

T 209.476.2910

Ryan.mcshane@cbre.com

www.cbre.com/ryan.mcshane

ANDREW MUSTIN

T 209.476.2930

Andrew.mustin@cbre.com

www.cbre.com/andrew.mustin

CB Richard Ellis

1776 W. March Lane, Ste. 170

Stockton, CA 95207

T 209.476.7800

F 209.476.2960

www.cbre.com/stockton

SITE PLAN

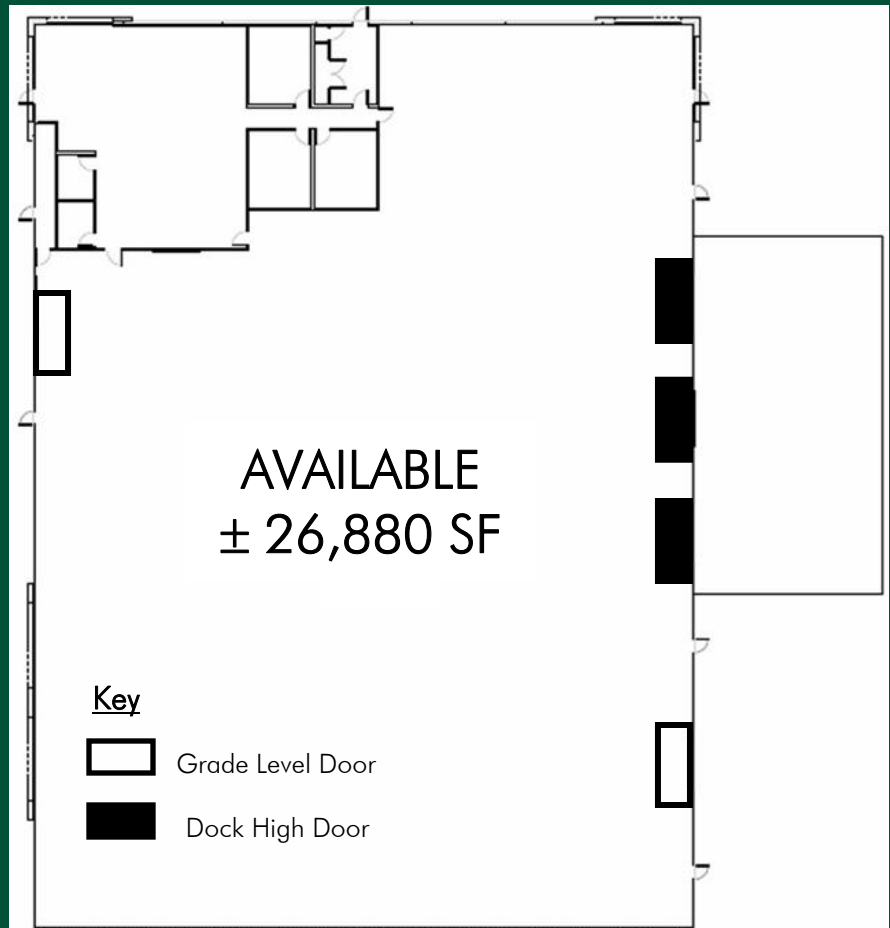

AREA MAP



VICINITY MAP



©2007, CB Richard Ellis, Inc. We obtained the information above from sources we believe to be reliable. However, we have not verified its accuracy and make no guarantee, warranty or representation about it. It is submitted subject to the possibility of errors, omissions, change of price, rental or other conditions, prior sale, lease or financing, or withdrawal without notice. We include projections, opinions, assumptions or estimates for example only, and they may not represent current or future performance of the property. You and your tax and legal advisors should conduct your own investigation of the property and transaction.

CBRE
CB RICHARD ELLIS